



CN4 - Lincat Silverlink 600 Free-standing Ambient Open-Top Pedestal without Doors - W 450 mm

Designed to suite with other products in the Silverlink 600 range, the Pedestal's adjustable shelf provides flexibility for storing bulky items.

- ✓ Designed to suite with the Silverlink 600 range
- ✓ Silverlink 600 counter-top units are securely attached to pedestals by means of fixing screws supplied
- ✓ Adjustable shelf provides flexibility for storing bulky items
- ✓ Adjustable feet for alignment even on uneven floors

Specifications

Summary

Brand	Lincat
Range	Silverlink 600
Unit Type	Free-standing
Available in UK Only	No
UK Warranty	2 Years Parts and Labour Warranty
Export Warranty	Contact your local dealer
GTIN	5056105100850

Weights and Dimensions

Unit Height (External) mm	660
Unit Width (External) mm	450
Unit Depth (External) mm	600
Height (Internal) mm	456
Width (Internal) mm	448
Depth (Internal) mm	567
Shelf Dimensions Width mm	400
Shelf Dimensions Depth mm	530
Net Weight Kg	14.3

Shipping

Packed Weight Kg	15.73
Packed Height cm	74.5
Packed Width cm	71.5
Packed Depth cm	53

Available Accessories

PSH4	450 PEDESTAL SHELF
------	--------------------

Technical Picture

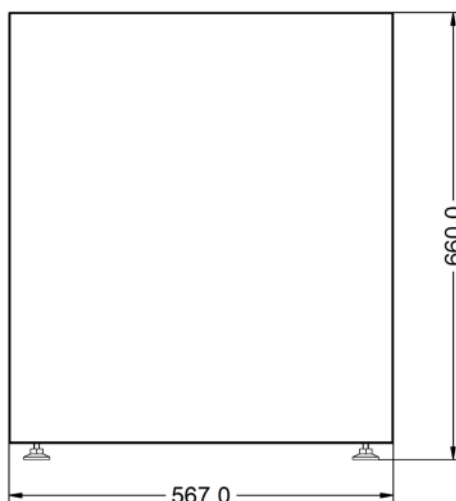
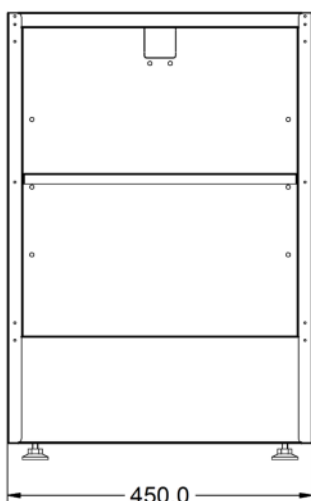
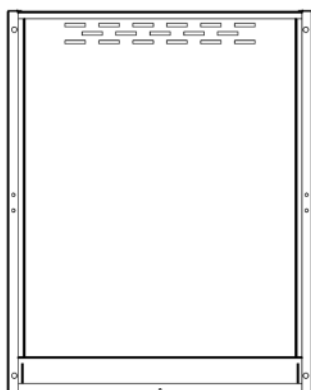

Lincat Limited

Whisby Road,
Lincoln, LN6 3QZ,
United Kingdom

Company No: 2175448

A member company of



Customer Care

Tel: +44 1522 875500

Email: care@lincat.co.uk

Export Customers

Tel: +44 1522 875536

Email: export@lincat.co.uk

Opening Hours

Monday – Friday:

8.30am – 5pm