



Chefmaster Blender with Sound Enclosure Instruction Manual

Model

HED244 – Blender with Sound Enclosure

Thank you for purchasing your Chefmaster Blender. To make full use of the product please read this manual carefully before using the product and keep it safe for future reference.

Safety Tips

- If you find any damage when the product is unpacked, contact your Chefmaster supplier within 24 hours of receipt of goods.
- Repairs should always be carried out by a qualified technician.
- Do not submerge the blender motor in water or any other liquid.
- Do not remove food debris from the product until the blade has come to a complete stop.
- Do not use this product outside nor place it in environments where there is open fire such as gas stove or kerosene stove in use.
- Always switch off and unplug the unit before cleaning.
- If the power cord becomes damaged it must be replaced by a qualified technician.
- This product is not designed to be used by persons with reduced physical or mental capabilities, lack of experience or knowledge, unless they are given suitable supervision, this includes children.
- The appliance is a high-power plug into a grounded outlet. Don't use an adapter. Don't use an extension cord.
- To reduce the risk of personal injury and prevent damage to the blender, don't touch or infield utensils into blender container while operating blender.
- Do not touch the control panel with a sharp instrument to avoid cracking, water seepage or damage to the internal control circuit.
- Do not start the blender when there is no ingredient in the container.

Pack Contents

- 1 x Chefmaster Blender
- 1 x Jug with Lid
- 1 x Sound Enclosure

Product Components

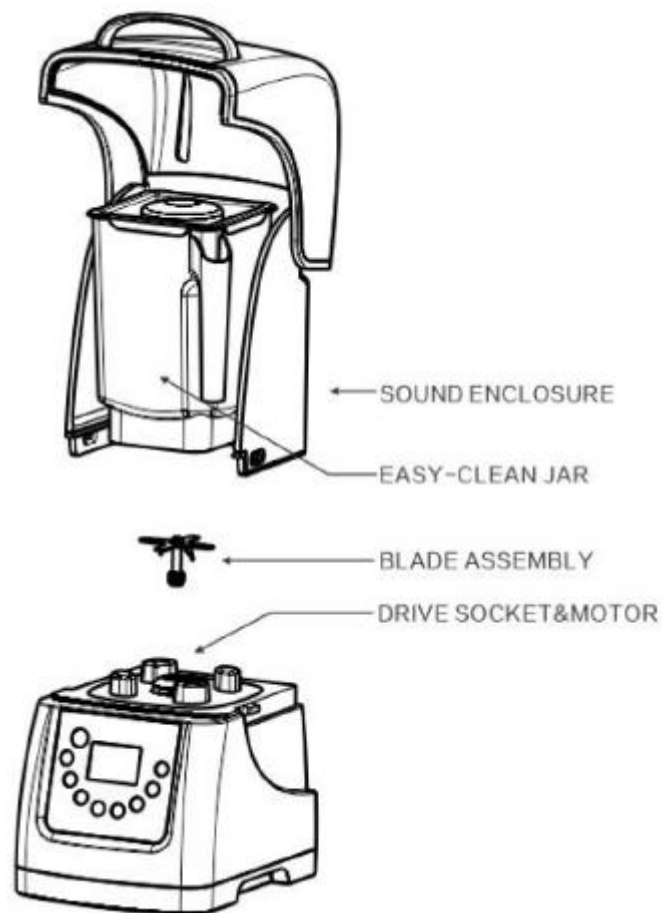

Before You Begin

Before using the Chefmaster Blender, ensure that the unit is wiped with a clean, damp cloth to remove any dirt or dust. Fill the jug with water to rinse the components. Dry thoroughly with a soft absorbent cloth.

Note: DO NOT submerge the jug / the motor base in water or use water sprays to clean it. They should only be cleaned with soft cloth.

Preparation

- Remove all packaging including all protective plastic, from your Chefmaster Blender.
- Place the jug on the motor base. Be sure the power switch is in “OFF” position.
- Assemble the sound enclosure to the motor base. A “click” sound should be heard for successful installation.
- Connect the plug into grounded outlet. Do not use an adaptor or extension cord.
- Put ingredients into the jug. The ingredients shall be put in accordance with the order: Soft ingredients > Hard ingredients > Liquid ingredients.
- Cover the jug with lid. Be sure the jug is tightly sealed with the lid.
- Close the lid of sound closure.
- Keep a distance for at least 20cm from the unit before starting the blender.

Operation

- Press “ON/OFF”  button & the display is on.
- Preset timer with “+” to add 30 seconds or “-” to reduce 30 seconds for each press.
- Preset speed with button “1”, “2”, “3” or “4”.
 - 1: Rotation speed = 15,000 rpm
 - 2: Rotation speed = 20,000 rpm
 - 3: Rotation speed = 25,000 rpm
 - 4: Rotation speed = 30.000 rpm

Note: Always preset the timer & speed before blending

- Press “START/STOP” button & the machine starts blending.
- The blender will stop automatically when time is up or either “START/STOP” (ON/OFF) button is pressed during the blending process.
- For instant high-speed blending, press “PULSE” button and hold until the required result is achieved. Release the button and the blender will run at the original speed.
- After the blending process is completed, press “ON/OFF”  button to switch off & the display goes off. The ingredients are ready to be taken out from jug when the blade stops spinning completely.

Cleaning & Maintenance

- Before cleaning disconnect the blender from the electricity supply
- Be careful when touching the blade – It is extremely sharp!
- Clean the inside of jug / lid / sound enclosure with warm soapy water.
- DO NOT submerge the jug / the motor base in water or use water sprays to clean it. They should only be cleaned with soft cloth.
- Dry before the product is stored.
- Always clean & check your Chefmaster Blender daily. Inspect the jug and blade assembly to ensure they are in good condition. DO NOT use broken, chipped, or cracked jug. DO NOT use wear, nicks, or broken blades.

Troubleshooting

Condition	Possible Cause	Solution
The unit is plugged in but not working	1. The unit is not switched on 2. The plug or lead are damaged 3. The fuse has blown 4. Overheat protection is triggered 5. The jug is not properly installed	1. Check the unit is correctly plugged in and switched on 2. Contact your Chefmaster distributor 3. Replace the fuse 4. Place the unit in a ventilated place, cool it for about 20 minutes, then press “reset” button on the base of motor 5. Place the jug on motor base until hearing a “click” sound
Excessive vibration	The motor base is not placed evenly	Place the motor on a flat & stable surface
	The jug is not installed properly	Clean the motor base with soft cloth & Install the jug again
	Excessive amount of ingredients is put in the jug	Adjust the amount of ingredients
Overflow	The amount of liquid exceeds the specification	Adjust the amount of liquid to around 1.5-1.8L
	Lid is not installed properly	Install the lid again, ensure the jug is tightly sealed

Technical Information

HED244 – Blender Digital with Sound Enclosure

Voltage 220~240v 50Hz

Power 2200watt

Weight 5.5kg

Capacity of Jug: 2 Litres

Dimensions 230mm x 254mm x 492mm (W x D x H)

- Chefmaster Blender is supplied with a 3 pin plug and lead with a 13 amp fuse.
- Appliance must be earthed.
- If in doubt contact a qualified electrician or your Chefmaster distributor.

Disposal



Under WEEE regulations this product must not be disposed of as household waste. To prevent damage to the environment and humans this product must be disposed of in an approved and environmentally friendly recycling process. For more information on how to dispose of this correctly please contact your Chefmaster distributor or local authority responsible for waste disposal.

Compliance



All Chefmaster parts and products have undergone a stringent testing process to ensure that they comply with all European standards and specifications.

All Chefmaster products carry the CE approval symbol.